

**Ideal planarity with the latest developments in high quality pictures.  
Supporting ultrashort focus projector  
Electric winding screen**

- A winding electric screen with superior flatness comparable to a fixed frame type.
- A side tension mechanism that applies tension from left and right of the screen.
- Sound transmission screen (WS 102, WS 103) is adopted.
- Simple design with flat panel.
- P selection mechanism enabled the fabric exchange.

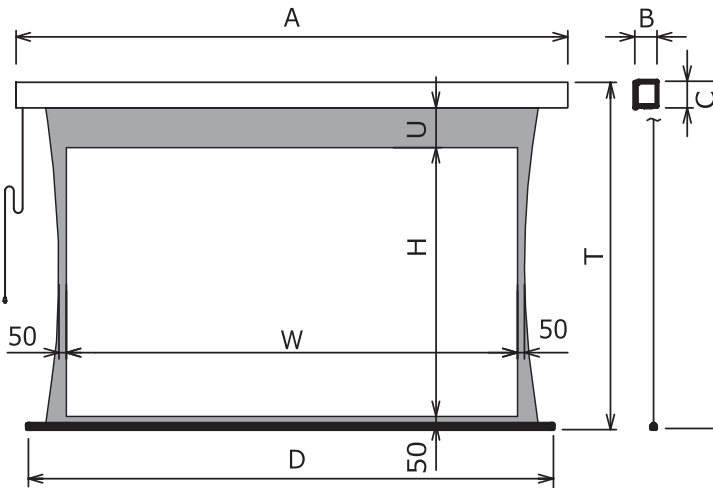

[Dimensional drawing]



Panel color is luxurious black.

Mounting brackets are equipped with sliding and side bracket as standard



Panel color (Black)



Sliding bracket  
(Except 130° ~ 150°)  
1set:2 pairs



Side bracket  
(130° ~ 150° are case integrated type)  
1set:2 pairs

[HD 16:9]

Size(inch)	Model	Image size W×H(mm)	Length A(mm)	Height T(mm)	UBB U(mm)	Depth B (mm)	Height when in stored C(mm)	Pipe length D(mm)	Weight (Kg)
100	STP-100HM-W1A/B/C/D	2214×1245	2747	2223	755	134	145	2566	17.9
110	STP-110HM-W1A/B/C/D	2435×1370	2968		630			2787	19.0
120	STP-120HM-W1A/B/C/D	2657×1494	3190		506			3009	20.1
130	STP-130HM-W1A/B/C/D	2878×1619	3411	2248	381	155	170	3230	33.2
140	STP-140HM-W1A/B/C/D	3099×1743	3632		257			3451	35.1
150	STP-150HM-W1A/B/C/D	3321×1868	3854		132			3673	36.9

\* The numbers of (T),(B) and (C) above indicate when sliding bracket is used and the numbers below indicate when side bracket is used.

[Fabric Lineup]

Size(inch)	Model	HF102	WF801	WF302	WF204	WG103	WS102 WS103	BU201
100	STP-100HM-W1A/B/C/D	●	-	●	-	-	●	-
110	STP-110HM-W1A/B/C/D	●	-	●	-	-	●	-
120	STP-120HM-W1A/B/C/D	●	-	●	-	-	●	-
130	STP-130HM-W1A/B/C/D	●	-	●	-	-	●	-
140	STP-140HM-W1A/B/C/D	●	-	●	-	-	●	-
150	STP-150HM-W1A/B/C/D	-	-	-	-	-	●	-

Manufactured by

**OSM CO.,LTD.**

278-3,kakehashi,Yamasaki-Cho,Shisou-Shi  
Hyogo,671-2523 Japan  
Tel.+81-790-64-5888 Fax.+81-790-62-9195

<https://www.os-worldwide.com/osm/>