

An electric screen with a steel case including necessary metal fitting, which is easily installed and ideal for the first buy, has a high cost performance.

- A symmetry structure easily makes focus the center of a screen.
- Easily peel off a central mark after installation.
- A mounting bracket and a cap are designed as an integrated side cap and produced by resin molding
- A circuit board is stored in a case.
- An attachable bracket by 3/8 bolt is adapted as a standard equipment.

[Dimensional drawing]

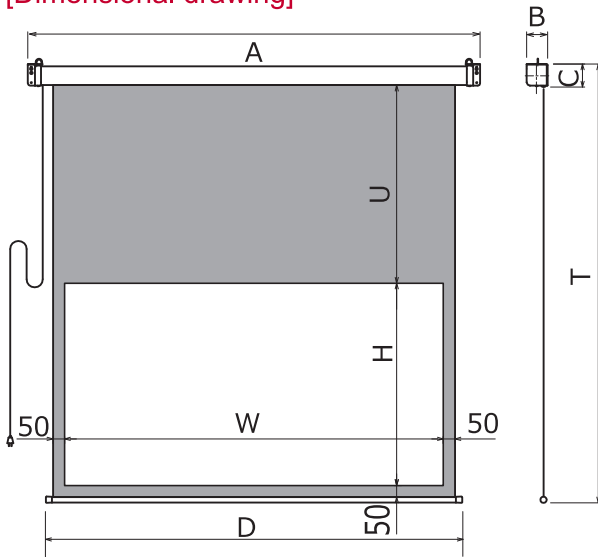

Infrared wireless remote controller



Integrated side-cap

[HD 16:9]

Size(inch)	Model	Image size W×H(mm)	Length A(mm)	Height T(mm)	UBB U(mm)	Side mask (mm)	Depth B(mm)	Height when in stored C(mm)	Pipe length D(mm)	Weight (Kg)
80	SEC-80HM-W1A/B/C/D	1771×996	2087	2265	1104	50	90	100	1932	9.3
100	SEC-100HM-W1A/B/C/D	2214×1245	2530		855				2375	11.2
120	SEC-120HM-W1A/B/C/D	2657×1494	2973		606				2818	12.0

[Fabric lineup]

Size(inch)	Model	HF102	WF801	WF302	WF204	WG103	WS102 WS103	BU201
80	SEC-80HM-W1A/B/C/D	-	-	-	-	●	-	-
100	SEC-100HM-W1A/B/C/D	-	-	-	-	●	-	-
120	SEC-120HM-W1A/B/C/D	-	-	-	-	●	-	-

Manufactured by

**OSM CO.,LTD.**

278-3,kakehashi,Yamasaki-Cho,Shisou-Shi  
Hyogo,671-2523 Japan  
Tel.+81-790-64-5888 Fax.+81-790-62-9195

<https://www.os-worldwide.com/osm/>