

INSTALLATION MANUAL

Thank you for purchasing the Projector hanger Kit P4-B. To ensure correct usage, thoroughly read this instruction manual.

This product is a kit for attaching the Extension Pole P1 and P1S. Customers who have purchased the Projector Hanger Kit P41-B or P42-B need to first install Extension Pole P1 or P1S.

For installation position and height, check the installation position recommended by the manufacturer in your projector instruction manual.



Applicable products

Projector

- SHARP XV-Z200
- SHARP XV-Z90
- SANYO LP-Z3
- SANYO LP-Z2
- SANYO LP-Z1X
- EPSON EMP-TW10H





* EPSON EMP-TW10H cannot be mounted on the right/left side of the Extension pole. Note that the upper or lower angle adjustment is also not available.

Extension pole

- HOMETHEATER P1/P1S

Safety Precaution

Ensure you follow the below Warnings and Cautions in order to correctly utilize the Screen.

	CAUTION	Indicates that failure to follow these safety precautions could result in bodily injury or damage to property.	
 Caution			
	Do not install any projector not applicable to this product. Do not install this product on any other than the extension pole.		Do not hang anything other than the projector from the projector installation part.
Prohibited	It may result in unexpected accidents or the projector falling.	Prohibited	It may result in damage, the hanger kit falling off or injury caused by the pole falling.

Please note we bear no responsibility for any troubles or damages due to inadequate installation, incorrect handling or natural disasters.

Specifications

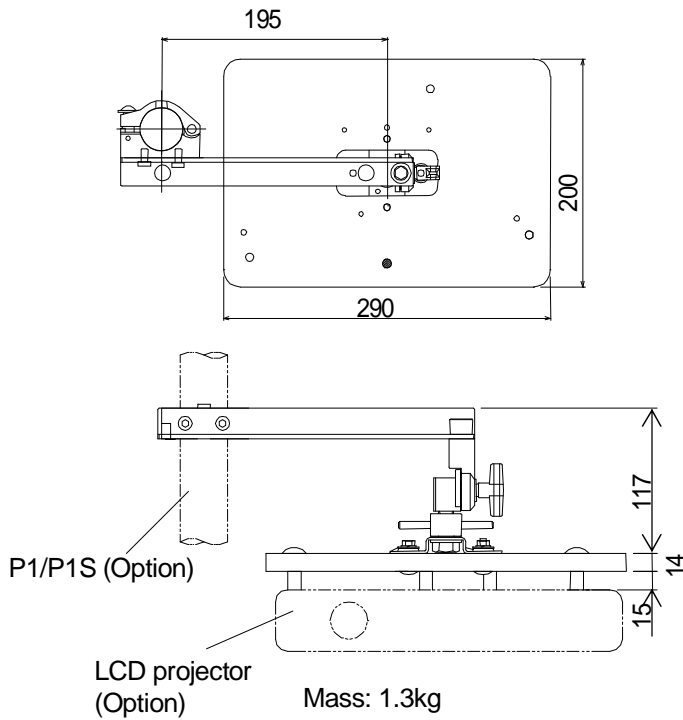

Mounting plate holes

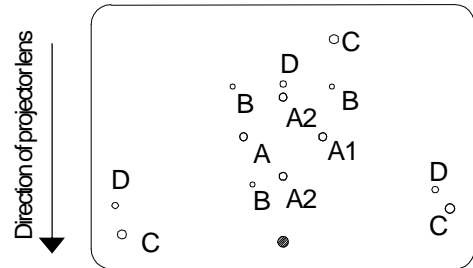

Hole A.....	Hanger bracket	For installation
Hole B.....	XV-Z20 (SHARP) XV-Z90 (SHARP)	For installation
Hole C	LP-Z3 (SANYO) LP-Z2 (SANYO) LP-Z1X (SANYO)	For installation
Hole D	EMP-TW10H (EPSON)	For installation

Note: Choose A1 or A2 based on the "projection direction, and whether it will have contact with a wall or the pole" for setting.

* Specifications and design are subject to change without notice in product improvement.

Parts list

First check that you have all the parts that should have been included with the main unit. If any are missing, immediately contact the shop you purchased it from.

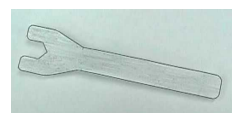

No.	Name of parts	Quantity
1	Clamp holder	1pc
2	Hanger bracket	1pc
3	Mounting plate	1pc
4	Spacer	L:3, S: 3
5	Hexagonal nut (M5)	2pcs
6	Hanger bracket screw (M6x12)	2pcs
7	Small truss head screw (M5x25)	2pcs
8	Small truss head screw (M6x40)	3pcs
9	Small truss head screw (M4x35)	3pcs
10	Small truss head screw (M3x35)	3pcs
11	Lock washer (M6)	3pcs
12	Lock washer (M5)	2pcs
13	Lock washer (M4)	3pcs
14	Lock washer (M3)	3pcs
15	Plain washer (M6)	3pcs
16	Plain washer (M5)	2pcs
17	Plain washer (M4)	3pcs
18	Plain washer (M3)	3pcs
19	Hexagonal bar spanner (Nominal: 5mm)	1pc
20	Spanner (Bifacial, width:8mm)	1pc

[Introduction]

Fix the extension pole in the specified position in advance.
Ensure you have a Phillips screwdriver on hand before starting.

1. Hanger bracket and clamp holder installation

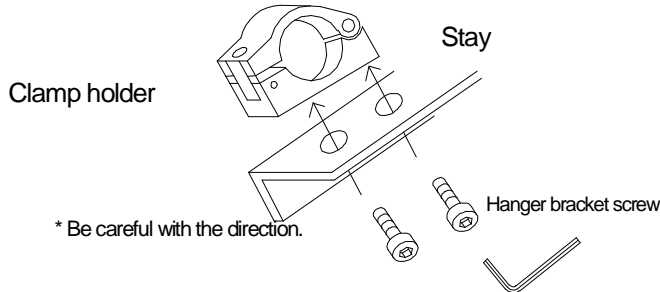

Fix the clamp holder and hanger bracket with hanger bracket screws and a hexagonal bar spanner.

2. Mounting plate and hanger bracket installation

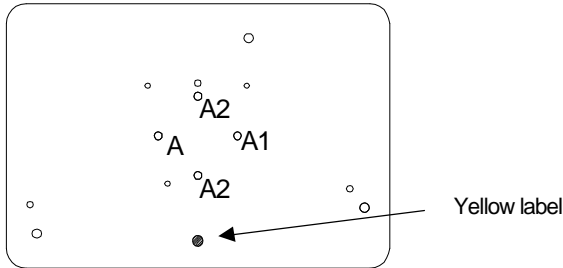

Position the yellow label surface upward and insert the small truss head screw into hole A1 (or A2) to install the hanger bracket at the center of the plate from beneath (Refer to specifications on page 2).

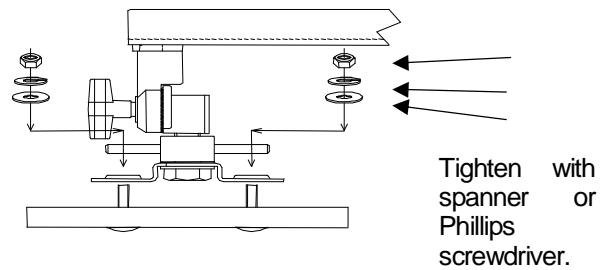

In this position, insert the plain washers, lock washers, and hexagonal nuts into the hanger bracket processed in 1 above, and tighten the small truss head screw with a Phillips screwdriver and spanner to install the plate.

3. Installation of mounting plate and projector (Mounting holes and screws depend on the projector to be mounted. Refer to "Mounting holes and screws" on page 4.)

(1) Place the projector with its bottom facing upwards on a flat work surface. Then align the direction of the yellow label on the mounting plate with that of the projector lens. Position the plate at the rear of the projector.

(2) Insert the small truss head screws and lock washers into the specified holes on the mounting plate from above. Tighten the screws with a Phillips screwdriver to fix the mounting plate and projector together after inserting the spacers between them from beneath.

(For the mounting holes and screws to be used, refer to Figure 1 below and page 4.)

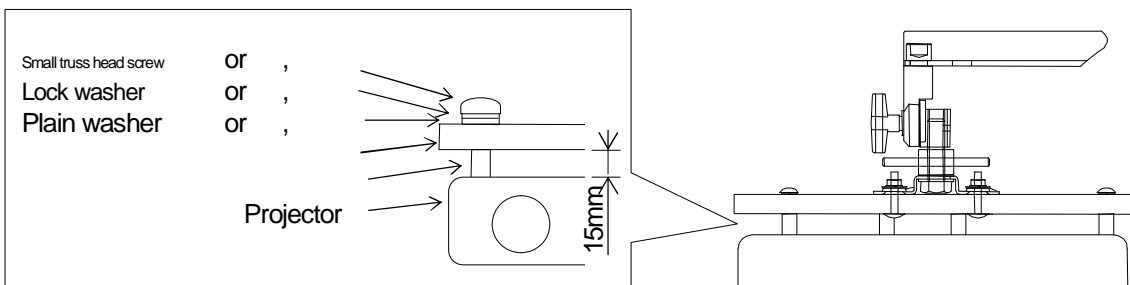

Mounting holes and screws

Mount the small truss head screws, spacers and washers in the specified place as shown in the table below.

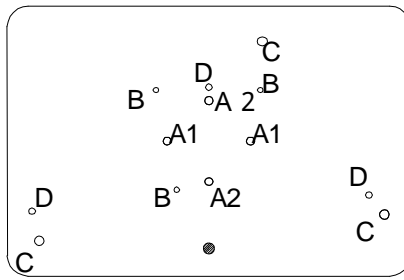

Projector lens side

Projector	Mounting hole	Small truss head screw	Spacer	Lock washer	Plain washer
XV-Z200 XV-Z90 (SHARP)	Hole B 3 points	(M3 x 35) Total 3 pcs	S Total 3 pcs.	S Total 3 pcs	S Total 3 pcs
LP-Z3 LP-Z2 LP-Z1X (SANYO)	Hole C 3 points	(M6 x 40) Total 3 pcs	L Total 3 pcs	L Total 3 pcs	L Total 3 pcs
EMP-TW10H (EPSON)	Hole D 3 points	(M4 x 35) Total 3 pcs	S Total 3 pcs	S Total 3 pcs	S Total 3 pcs

(A1 and A2 are the hanger bracket mounting holes.)

4. Joint with extension pole

Loosen the clamp holder with the hexagonal bar spanner to open it. Next, insert the clamp into the extension pole and fix the button bolt in the specified place. Then tighten it with the hexagonal bar spanner. Finally check that the clamp holder is securely fixed to the pole.

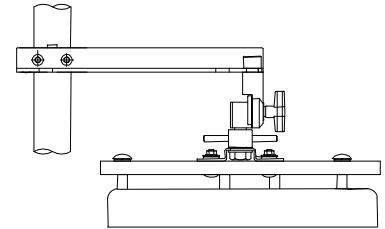

⚠ Caution

Ensure that the clamp holder is securely fixed to the extension pole. If it is loose, the machine may fall off or the projector may fall out, resulting in damage to this product or your property.

5. Angle adjustment

Right and left angle adjustment

Turning the turn lock handle on the hanger bracket (clockwise -> tighten) in the specified place determines the horizontal angle and also increases mounting plate stability.

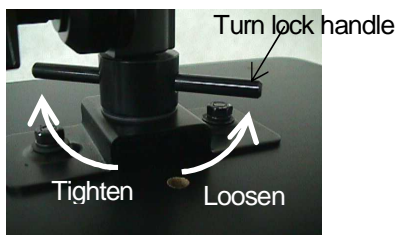

Upper and lower angle adjustment

Loosen the angle adjustment knob on the hanger bracket (counterclockwise) to adjust the angle of the mounting plate (in the vertical plane). Then retighten the knob again to fix the plate in position.

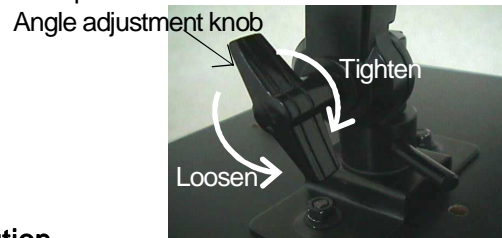

⚠ Caution

When adjusting projector height, ensure the mounting plate is removed from the pole. Do not adjust height with the projector mounted. It may result in the machinery fall or the projector fall out.

Installation tips

Projectors have various image correction functions such as trapezoidal correction, etc. However, projectors can achieve the best intrinsic performance by not utilizing such functions when projecting images onto a screen. If the angle adjustment function of this product will be used, thoroughly read the installation description in the instruction manual of your projector.